

INDUCTION TACHOMETERS

FOR INSTANTANEOUS MEASUREMENT OF ROTATION SPEED

dial
Ø mm 60-80



- dial available with different scales on request.
 - ratio between dial indication and actual turns on request
 - drive shafts mounted on ball bearing (sealed version on request)
 - magnetic induction compensation when temperature varies
 - maximum operating temperature: 70°C
 - tolerance +0.5 of the scale's end value starting from 90°
 - indicator hand with perfectly balanced axis
- **materials:**
see specific characteristics of models
 - **scale's end:**
see specific characteristics of models

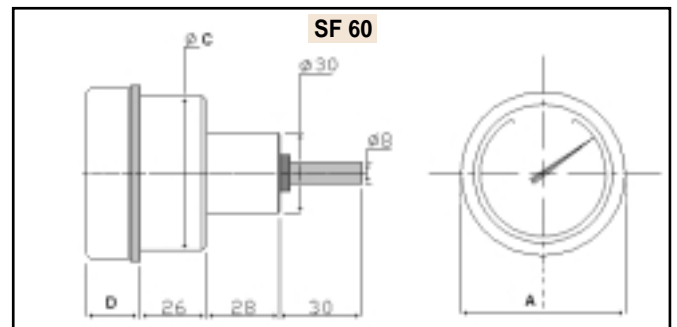
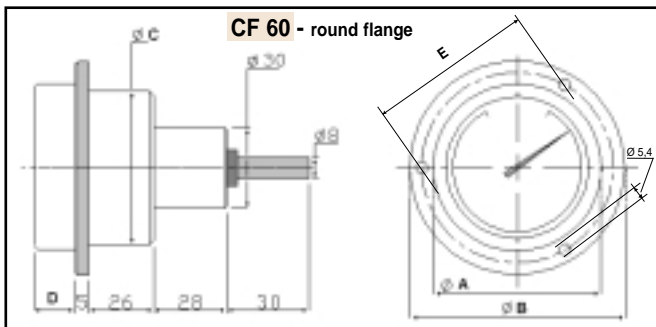

- ☑ **SF 60** Scale's end can be reached with speed of between 100 and 5000 turns/minute. ♦ Materials : body in aluminium
- ☑ **CF 60** flange (in mod. CF) in aluminium.

Mod.	measurement A	measurement B	measurement C	measurement D	measurement E	weight gr.
SF 60	65	\	60	21	\	300
CF 60	65	83	60	16	74	300

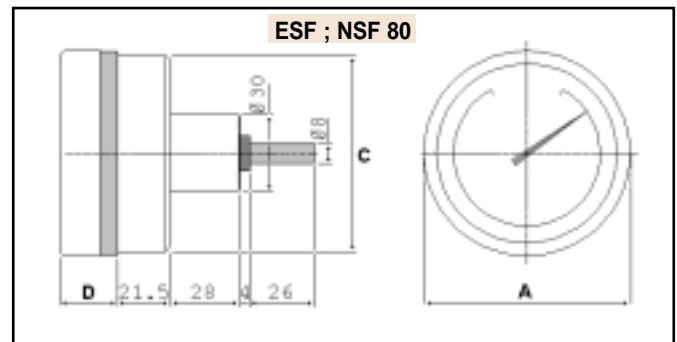
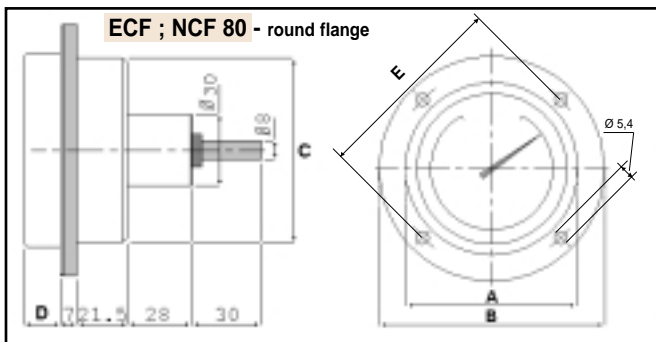

- ☑ **ESF 80** Scale's end can be reached with a speed of between 200 and 3000 turns/minute. ♦ Materials: body in Nylon PA66
- ☑ **ECF 80** loaded glass - flange (in mod. ECF) in ABS.
- ☑ **NSF 80** Scale's end can be reached with a speed of between 100 and 5000 turns/minute. ♦ Materials: body in aluminium
- ☑ **NCF 80** flange (in mod. NCF) in ABS.

Mod.	measurement A	measurement B	measurement C	measurement D	measurement E	weight gr.
ESF 80	83	\	80	23	\	400
ECF 80	83	110	80	16	95	500

TACHOMETERS



dial Ø mm 60-80

INDUCTION TACHOMETERS FOR INSTANTANEOUS MEASUREMENT OF ROTATION SPEED

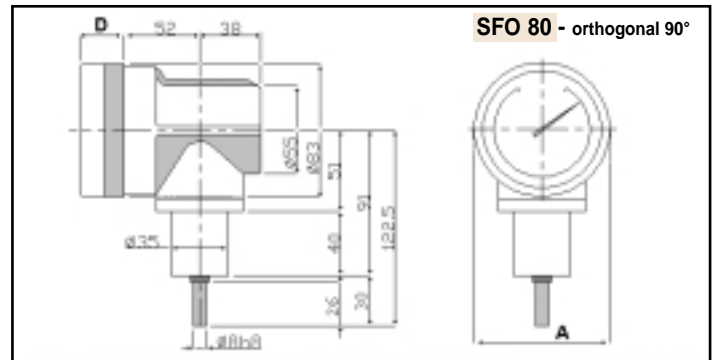
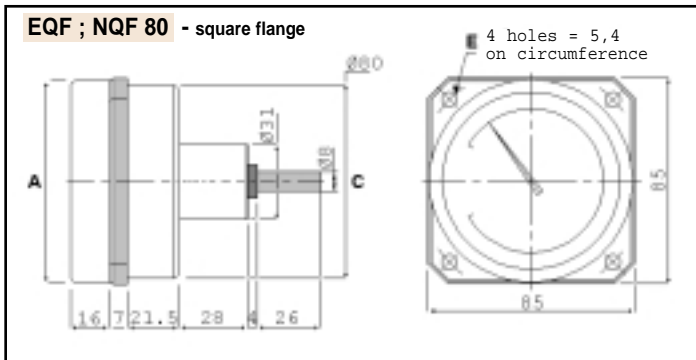

☑ **EQF 80** Scale's end can be reached with speed of between 200 and 3000 turns/minute. ❖ Materials: body in Nylon PA 66 loaded glass - flange in ABS.

☑ **NQF 80** Scale's end can be reached with speed of between 100 and 5000 turns/minute. ❖ Materials : body in aluminium flange in ABS.

☑ **SFO 80** Scale's end can be reached with speed of between 100 and 5000 turns/minute. ❖ Materials: body in aluminium.

Mod.	measurement A	measurement B	measurement C	measurement D	measurement E	weight gr.
NQF 80	83	\	80	\	95	350
SFO 80	83	\	\	23	\	800

CONNECTIONS

A Standard connection
Bare shaft
- for all models -

B Connection for flexible transmission M30 x 1,5
- only for Ø 80 -
- mod.: NQF,NCF,NSF -

C Connection for flexible transmission 1" GAS
- only mod.: SFO -

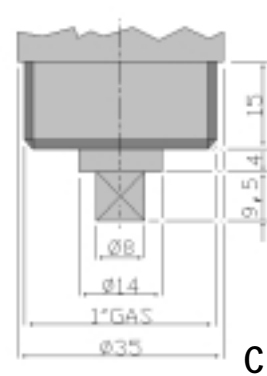
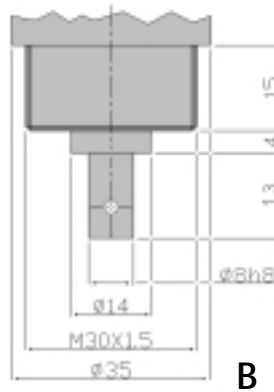

Position of drive shafts for 90° orthogonal type

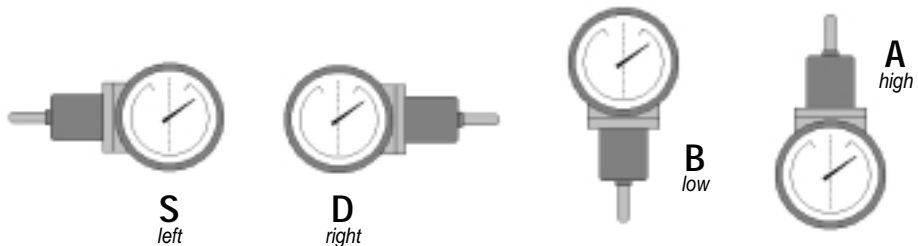

Direction of drive shaft rotation

When placing the order please specify:

- ▶ Type of device indicating the diameter of the dial → ESF 80 ; NQF 80...etc. ;
- ▶ Graduation of the scale and indications → turns / min. ; mt / min. ; etc.
- ▶ Numbers of turns after 1st turn of the drive shaft corresponding to the scale's end → 300 ; 1000 ; 3000 ; etc.
- ▶ Position of shaft outlet (only in the orthogonal type) → A ; B ; D ; S ;
- ▶ Direction of rotation → Dx ; Sx ;

