

# INDUCTION TACHOMETERS

## FOR INSTANTANEOUS MEASUREMENT OF ROTATION SPEED

dial  
 $\varnothing$  mm 160-200



- dial available with different scales on request.
  - ratio between dial indication and actual turns on request
  - drive shafts mounted on ball bearing (sealed version on request)
  - magnetic induction compensation when temperature varies
  - maximum operating temperature: 70°C
  - tolerance +0.5 of the scale's end value starting from 90°
  - indicator hand with perfectly balanced axis
- **materials:**  
see specific characteristics of models
  - **scale's end:**  
see specific characteristics of models

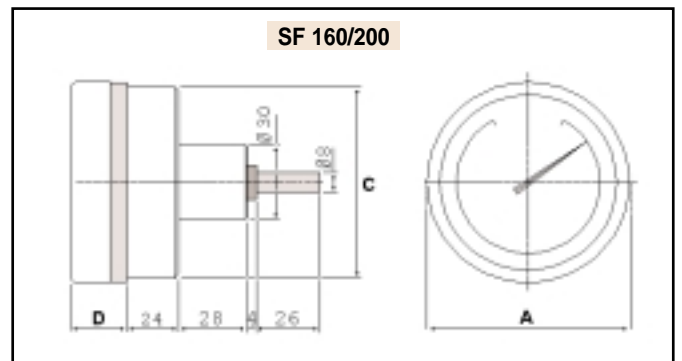
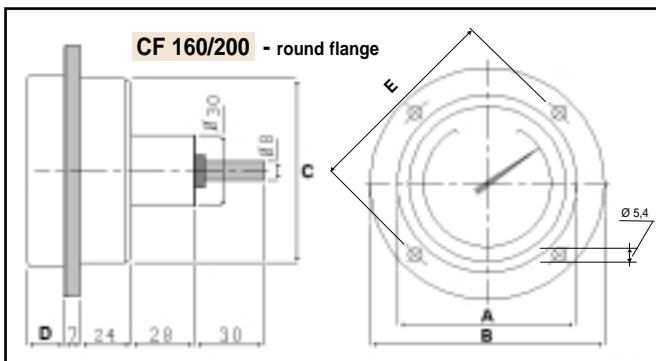

- ☑ **SF 160** Scale's end can be reached with speed of between 100 and 5000 turns/minute. ❖ Materials : body in aluminium flange (in mod. CF) in aluminium.
- ☑ **CF 160**
- ☑ **SF 200** Scale's end can be reached with speed of between 100 and 5000 turns/minute. ❖ Materials : body in aluminium flange (in mod. CF) in aluminium.
- ☑ **CF 200**

Mod.	measurement A	measurement B	measurement C	measurement D	measurement E	weight gr.
<b>CF 160</b>	163	194	80	17	178	1000
<b>SF 160</b>	163	\	80	24	\	900
<b>CF 200</b>	207	250	80	17	226	1350
<b>SF 200</b>	207	\	80	24	\	1250

TACHOMETERS

### CONNECTIONS

**A** Standard connection  
bare shaft  
- for all models -

**C** Connection for flexible transmission 1" GAS  
- for all models -

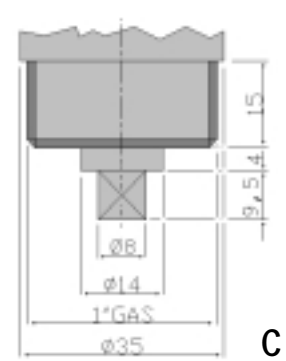

# dial Ø mm 160-200

# INDUCTION TACHOMETERS FOR INSTANTANEOUS MEASUREMENT OF ROTATION SPEED

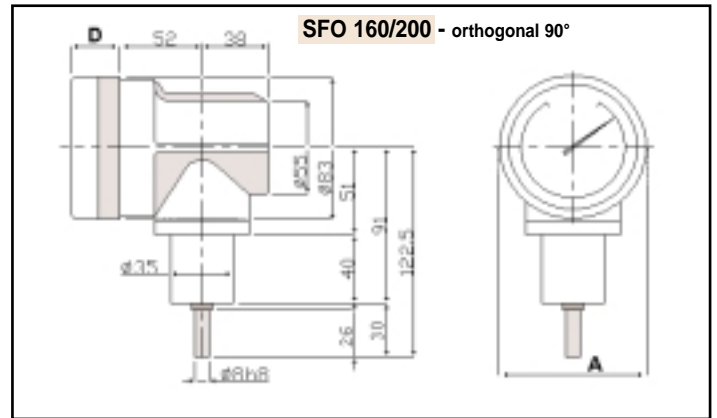
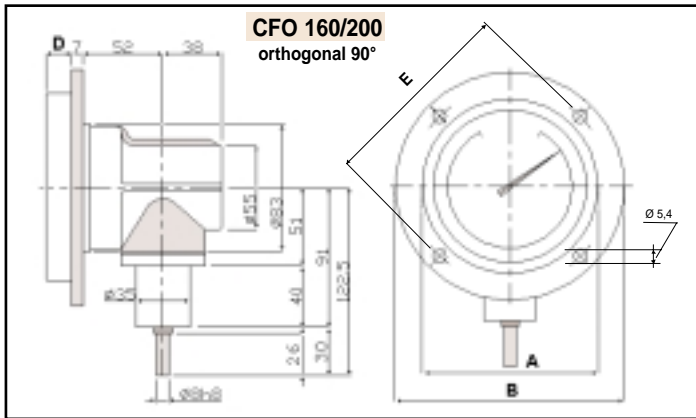

- ☑ **SFO 160** Scale's end can be reached with speed of between 100 and 5000 turns/minute. ❖ Materials : body in aluminium flange (in mod. CF) in aluminium.
- ☑ **CFO 160** Scale's end can be reached with speed of between 100 and 5000 turns/minute. ❖ Materials : body in aluminium flange (in mod. CF) in aluminium.
- ☑ **SFO 200** Scale's end can be reached with speed of between 100 and 5000 turns/minute. ❖ Materials : body in aluminium flange (in mod. CF) in aluminium.
- ☑ **CFO 200** Scale's end can be reached with speed of between 100 and 5000 turns/minute. ❖ Materials : body in aluminium flange (in mod. CF) in aluminium.

Mod.	measurement A	measurement B	measurement C	measurement D	measurement E	weight gr.
<b>CFO 160</b>	163	194	\	17	178	1400
<b>SFO 160</b>	163	\	\	24	\	1300
<b>CFO 200</b>	207	250	\	17	226	1750
<b>SFO 200</b>	207	\	\	24	\	1650

**AI:** dial with double rotation direction

**BIF:** bi-frontal dial

**Other special versions on request:**

**QMS:** dial with two or more scales

**M:** overgear - for very low speeds

**T:** odometer with 5-6 digits that can be set to zero

**R:** straightener

**EV:** adjustable minimum and/or maximum electric contact

**Position of drive shafts for 90° orthogonal type**

**Direction of drive shaft rotation**

**When placing the order please specify:**

- ▶ Type of device indicating the diameter of the dial → CF 160 ; CFO 160...etc. ;
- ▶ Graduation of the scale and indications → turns / min. ; mt / min. ; etc.
- ▶ Numbers of turns after 1<sup>st</sup> turn of the drive shaft corresponding to the scale's end → 300 ; 1000 ; 3000 ; etc.
- ▶ Position of shaft outlet (only in the orthogonal type) → A ; B ; D ; S ;
- ▶ Direction of rotation → Dx ; Sx ;

TACHOMETERS

