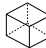

KME 06

6-DIGIT METER HEAVY DUTY RESETTABLE

- **6-digit h = 8 mm display**
white digits on black background (whole)
white digit on red background (decimal)
or all white on black background
(without decimal)
- **quick resetting lever**
- **materials**
die-cast zamak body
ABS casing
command shaft in AISI 303
self-lubricating synthetic material kinematic
motion devices
- **max speed**
500.0 meters / min.

 gr. 790

 mm 170 x 70 x 55



TYPICAL APPLICATIONS

Cloth - tape - rope - extruded materials -
etc... measurements

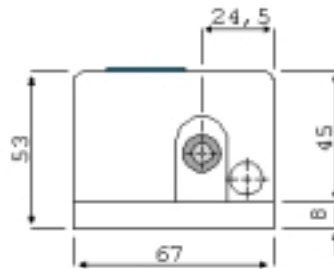
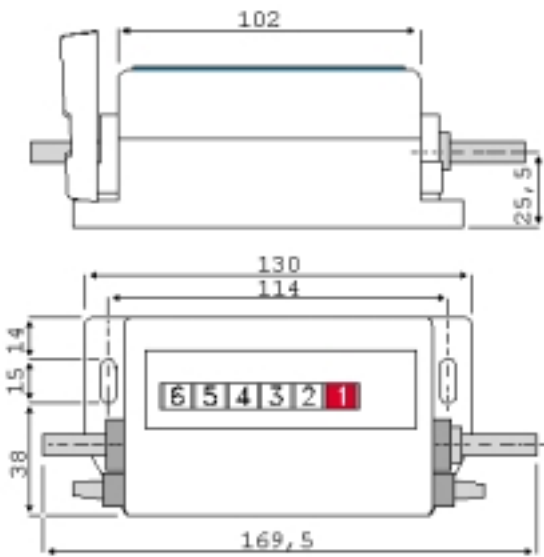

COD.	MOD.	RATIO	SHAFT OUTPUT	ROTAT. 
FC0875/003	KME 06 D	2 revol. / 1 meters	passing	right
FC0875/004	KME 06 S	2 revol. / 1 meters	passing	left
FC0875/005	KME 06 D	1 revol. / 0.5 meters	passing	right
FC0875/006	KME 06 S	1 revol. / 0.5 meters	passing	left

Note :

-

COD.	RIF.	DESCRIPTION	Ø mm.	STRIP WIDTH mm
FV0085/071	[c]	Rubberized moplen wheel Development = 500 mm	159.15	23
FV0085/073	[c]	Aluminium wheel+rubber strip Development = 500 mm	159.15	23

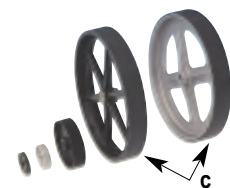

	CODE INDICATION		
	model	shaft rotation	gear ratio
example of order	KME 06	S	1/5
description		<i>left</i>	<i>5 rounds per meter with red decimal</i>

METERS

